

(Endorsement on back)  
 Philadelphia  
 Part of Wind Mill Island  
 305.70 ps  
 Thomas G. & B. M. Smith  
 Rec'd Dec. 13<sup>th</sup>, December, 1853  
 61  
 Accepted 13 Decr 1853  
 290

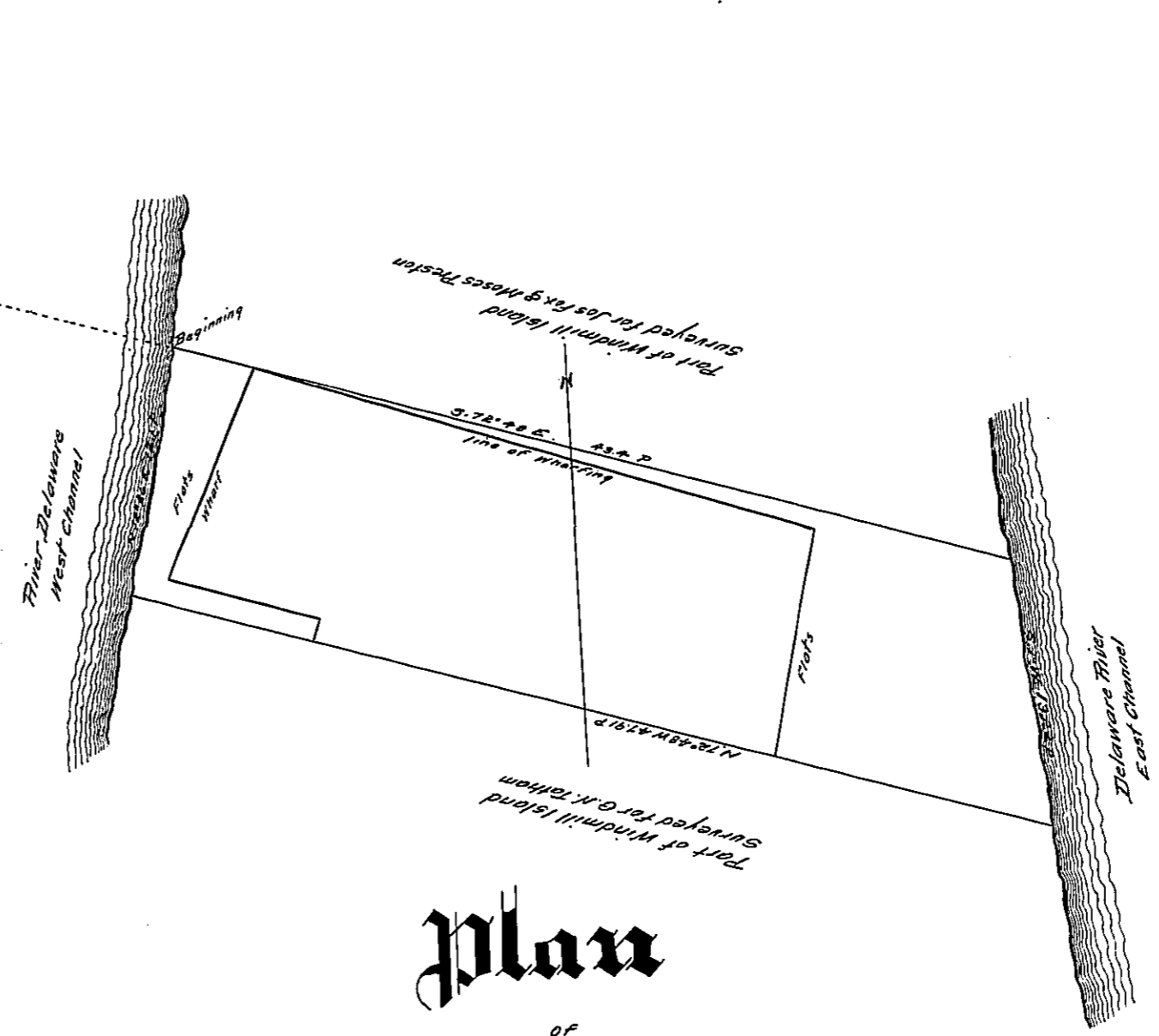

# Plan

OF  
 Part of Windmill Island in the River Delaware in the County of Philadelphia opposite the City of Philadelphia containing Three Acres and seventy perches surveyed Oct 6 1853 by virtue of a warrant from the land office dated Sep 28 1853 by Isaac Shallerross D.S.

To J. Porter Brawley Esquire Surveyor General of the Commonwealth of Pennsylvania -  
 Pursuant to a warrant under the seal of the Surveyor General's office of Pennsylvania to me Directed dated the twenty eighth day of September A.D. 1853 to me directed authorizing and requiring me to survey to Thomas G. Smith and Robert W. Smith an Island situate in the Delaware river in the County of Philadelphia and opposite the City of Philadelphia Commonly called Windmill Island Bounded on the N by a certain survey made for Jos. Fox and Moses Preston of ten acres and ninety perches of Flat at the N end of said Island patented to them Decr 30<sup>th</sup> 1851 &c and bounded on the S by a certain survey made for G. M. Tatham patented to him April 29 1853 &c and bounded on the E and W by low water mark of the river Delaware containing about three acres. I proceeded on the sixth day of October 1853 to survey the same and find it to be as follows. Beginning at low water mark of the River Delaware on the Northwest side of said Island and at the distance of about one hundred and thirty feet nine inches Southward from the line of the fronts of the buildings on the south side of Chesnut street in the City of Philadelphia extended Southeastward across the said River. Thence by a line parallel with the line of the fronts of the buildings on the south side of Chesnut street as aforesaid and by part of said Island patented to Joseph Fox and Moses Preston as aforesaid South seventy two Degrees forty eight minutes East forty three perches and four tenths of a perch to low water mark of the said River Delaware on the south east side of said Island Thence down the said river Delaware by low water mark the several courses thereof the General course being South seven Degrees East Thirteen perches and twenty two hundredths of a perch to a corner Thence by a line parallel with the fronts of the buildings on the south side of Chesnut street as aforesaid and at the distance of two hundred feet southward from the North line of this survey North seventy two Degrees forty eight minutes West forty seven perches and ninety one hundredths of a perch to low water mark of the said River Delaware on the Northwest side of said Island Bounded by part of said Island patented to George M. Tatham. Thence by low water mark of the said River Delaware the several courses thereof the General course being North Twelve Degrees and twenty six minutes East Twelve perches and one tenth of a perch to the place of beginning containing Three acres and seventy perches N.B. The Northernly line of this survey if <sup>extended</sup> extended Northwestward across the River Delaware will strike the south side of the South Mall at the brick store marked for the directory of the City of Philadelphia No 28 of South Market. A plan of the above survey is herewith annexed Nov 21 1853.

With Great Respect  
 Isaac Shallerross D.S.

In Testimony, That the above is a copy of the original remaining on file in the Department of Internal Affairs of Pennsylvania, made conformably to an Act of Assembly approved the 16th day of February, 1833, I have hereunto set my hand and caused the Seal of the said Department to be affixed, at Harrisburg, the fifth day of July A.D. 1854

Henry Howell  
 Secretary of Internal Affairs